

Miniature HD Lens



Description

The DSL901 is a multi-element glass lens designed for 2/3" imagers with up to 1.3MP resolution. The compact form factor of the DSL901 relative to the large imager format size makes this lens ideal for size constrained machine vision applications.

Key Features

- Compatible with large format imagers
- All-glass to optimize thermal stability

Optical Specifications

Sunex PN DSL901	
Description	Miniature Imaging Lens
Imager Format	2/3"
Nominal Imager Resolution	1.3MP
Focal Length	12.0mm
Relative Aperture (F/#)	F/3.0
Image Circle	12.0mm
Field of View	33° at 7.1mm image circle 39° at 8.5mm image circle 50° at 11.0mm image circle
Total Track Length	20.9mm
Distortion	<1% rectilinear
Chief Ray Angle	13.6° at 11.0mm image circle, linear
IR cut-off filter	Optional 650nm IR cutoff filter

Applications

- Machine Vision
- Security/Surveillance

DSL901C-NIR-F3.0 Mechanical Dimensions [mm]:

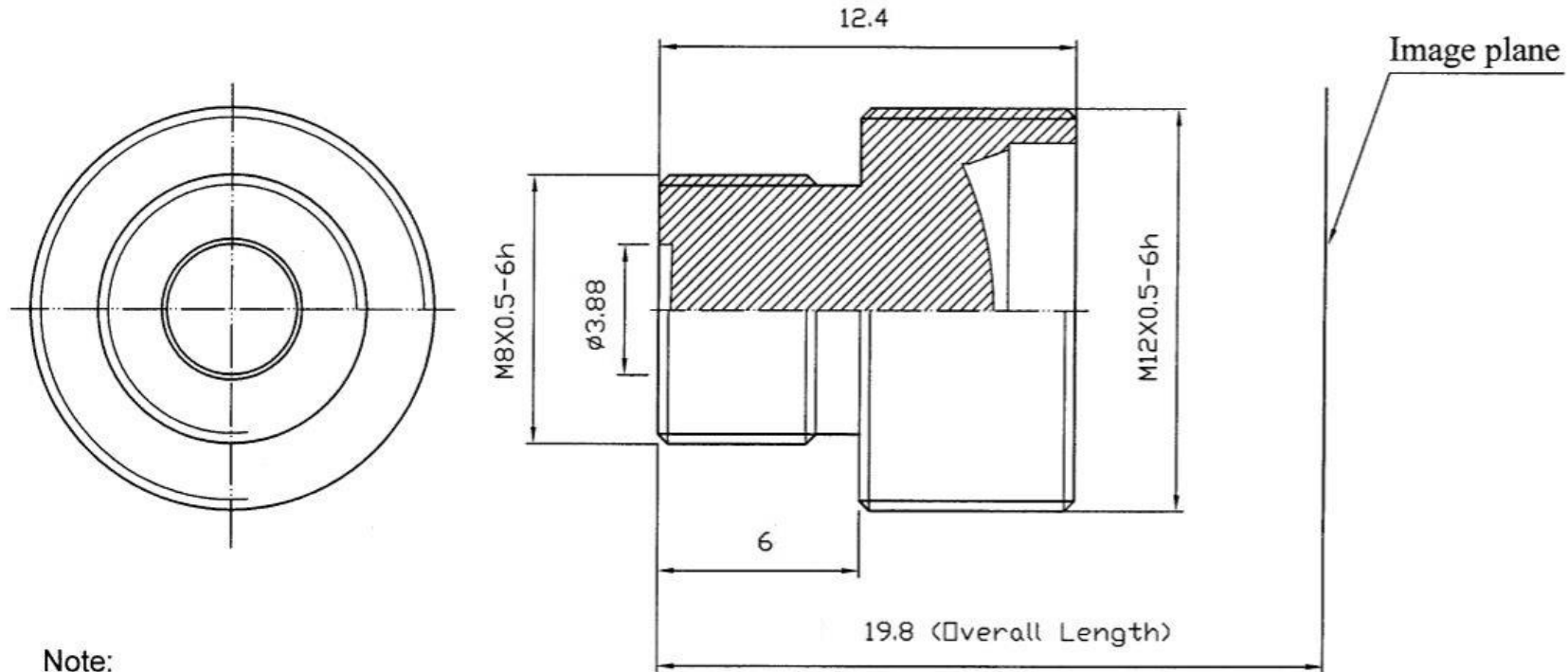

Note:

- 1. Barrel material: AL6061
- 2. EFL=12.0mm
- 3. F/#=3.0

DSL901E-NIR-F3.0 Mechanical Dimensions [mm]:

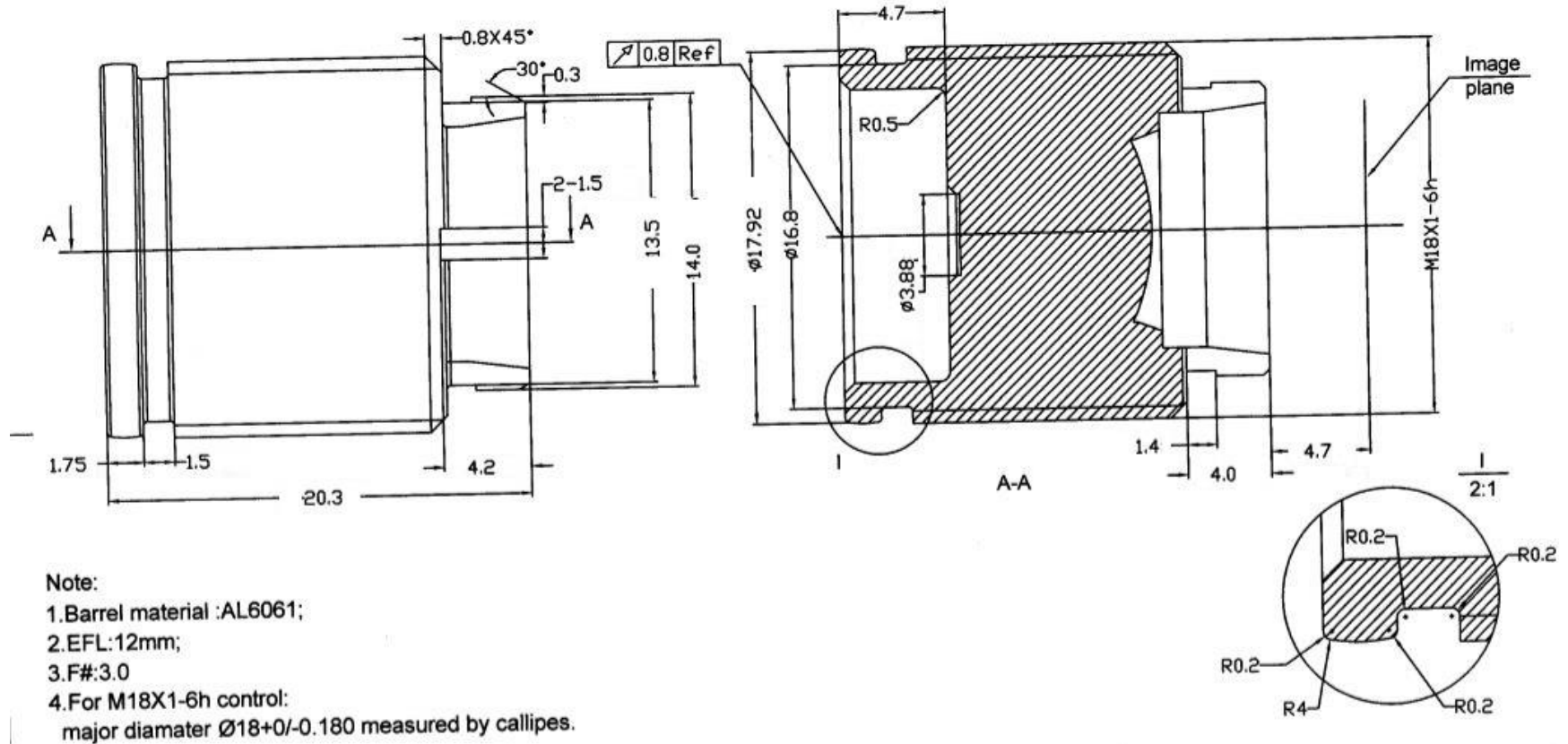

DSL901J-650-F3.0 and DSL901J-NIR-F3.0 Mechanical Dimensions [mm]:

Note: DSL901J is intended for use with the Sunex CMT103, CMT104 or CMT107 mount.

